

Core drill technology

BED 55

Order no. 257.081



Technical attributes	BED 55
Power input	1200 Watt
Power output	700 Watt
Speed under load 1st/2nd/3rd gear	350-1000 / 800-2300 / 1600-4600 rpm
Tool fixture	G 1/2"
Diamond drill bit Ø	12-85 mm
Surface area occupied by stand	420 x 120 mm
Weight (complete unit)	17,2 kg

Standard equipment

Water collection up to 50 mm Ø	256.370
1 GFCI operator protection circuit breaker in cord	256.790
Stationary drill stand BD 05	254.436

Advantages at a glance

- FLEX triple VR electronics: with consistent speed control by tachometer generator, overload protection, and speed selection
- Stationary drill stand: with precision column guide, drill stroke up to 300 mm
- Integrated water supply: through the gear head
- Water collector with suction cup: for collecting water, even on stairs
- Drill bit connection: G 1/2"
- Safety slip clutch: offers protection if the core drill is jammed
- GFCI operator protector circuit breaker: integrated in cord
- Quality shut-off carbon brushes: if the carbon brushes wear down, the motor will be automatically switched off and thus protected from damage

The FLEX core drilling unit for confined areas

The slim, stable drill stand, lateral supports and long feed column are characteristic of this drilling unit, enabling drilling of the next higher step from a lower one. Swivelling the feed column enables drilling in corners and recesses on banisters, gravestones and baths. Drilling speed can be adapted to any bit diameter (12-85 mm) thanks to mechanical 3-speed gearing and VR full-wave electronic control.

Core drill technology

Accessories

Diamond drill bits for marble and granite

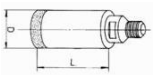

wet, G 1/2", external thread, effective length 100 mm, continuous segments for 12-15 mm Ø, divided segments for 18-65 mm Ø

Diameter in mm:	QTY/PKG:	Order no.
12 Ø	1	254.563
14 Ø	1	254.564
15 Ø	1	258.753
25 Ø	1	254.567
30 Ø	1	254.566
42 Ø	1	254.882
45 Ø	1	258.755

Diamond core drill bits for concrete



wet, G 1/2", external thread, effective length 300 mm

Diameter in mm:	QTY/PKG:	Order no.
42 Ø	1	258.769
52 Ø	1	258.770



wet, G 1/2", external thread, effective length 400 mm

Diameter in mm:	QTY/PKG:	Order no.
40 Ø	1	252.592

Core drill technology

Sharpening stone for diamond tools



Dimensions in mm:	QTY/PKG:	Order no.
----------------------	----------	-----------

320 x 160 x 30	1	251.756
-------------------	---	---------